

FLUSH VALVE REBUILD INSTRUCTIONS

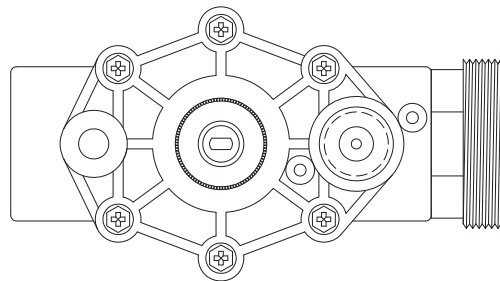
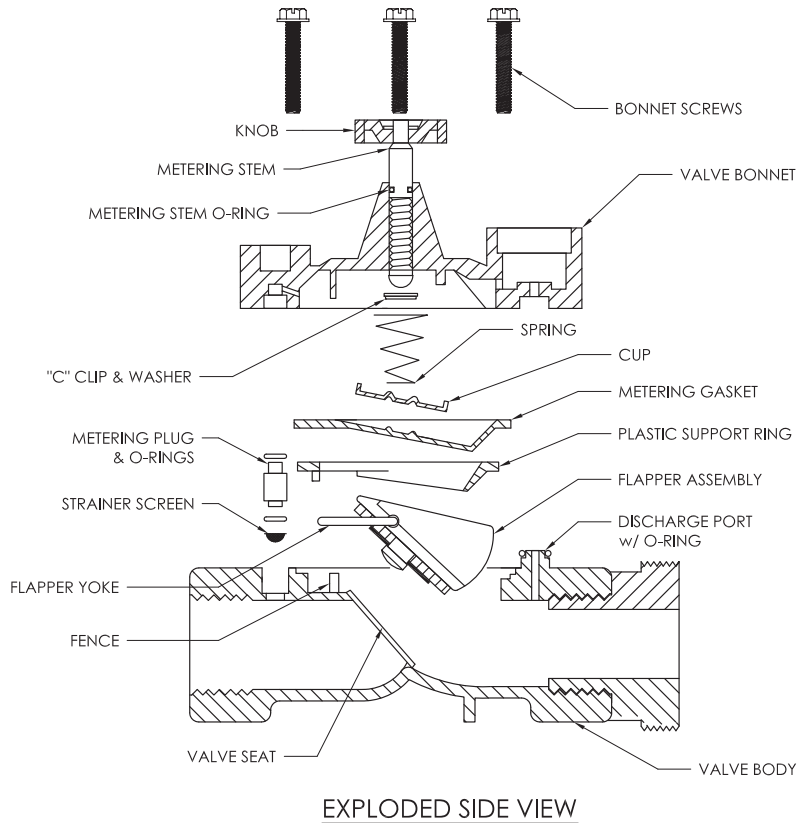

1. Remove (6) **bonnet screws** and **valve bonnet** from **valve body**.
2. Remove any o-rings (on inlet or discharge side) from the under-side of valve bonnet.
3. Remove **metering plug** from inlet side of valve body - inspect, clean and reuse – replacement o-rings in kit (spare metering plug in kit if needed).
4. Remove **strainer screen** from under metering plug on inlet side – replacement screen in kit.
5. Remove **metering gasket and cup assembly** – discard, replacement gasket and cup in kit.
6. Remove **plastic support ring** – discard, replacement support ring in kit. ** There are (2) support rings in your kit. If your flush valve body is black then you must use the **green** support ring provided. The **green** support ring will be marked with "3711-SR" on the bottom lip. If your flush valve body is **blue** then you must use the **blue** support ring provided. The **blue** support ring will be marked with "3801-SR" on the bottom lip.
7. Remove **flapper assembly** – discard, replacement flapper assembly in kit.
8. Inspect **valve seat**. Seat should be smooth and free of debris, nicks or cuts.
9. Install new flapper assembly. Screw head faces down into the valve seat. **Flapper Yoke** hooks on **Fence**.
10. Install the new plastic support ring.
11. Install new metering gasket. Note that the gasket is held in place by a beaded edge that fits into matching grooves on valve body and bonnet.
12. Install new cup. Cup faces up towards valve bonnet.
13. Install new strainer screen (under metering plug on inlet side).
14. Replace o-rings on metering plug and re-install metering plug on inlet side. Make sure plug has **o-rings** on both sides. Install "cupped end" down into valve body.
15. Install new o-ring on **discharge port stem** of valve body.
16. Reassemble valve bonnet to valve body using (6) bonnet screws. The solenoid port on the valve bonnet is on discharge side of valve. Alternate screws when tightening.
17. Reset the valve to I-CON standard settings. Turn the metering stem clockwise as far as it will go. Then turn the metering stem back counter-clockwise two (2) FULL turns. Valve volume is now reset.